

SmartAX MT882a ADSL CPE Quick Start

1 Connecting the Cables

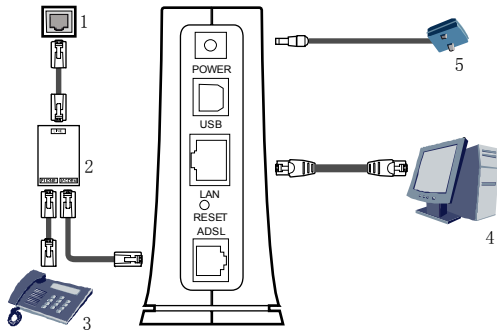

1 Telephone jack on the wall

2 Splitter

3 Telephone

4 Computer

5 Power adapter

To connect the cables, do as follows:

- Step 1** Connect the telephone jack on the wall to the LINE interface on the splitter with a telephone line. Connect the telephone to the PHONE interface on the splitter with a telephone line.

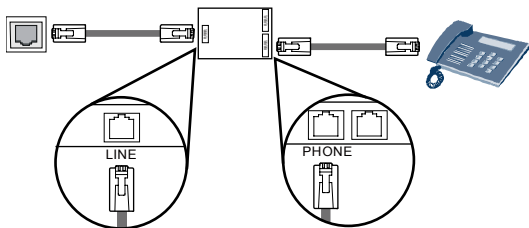

- Step 2** Connect the ADSL interface on the MT882a to the Modem interface on the splitter with a telephone line.

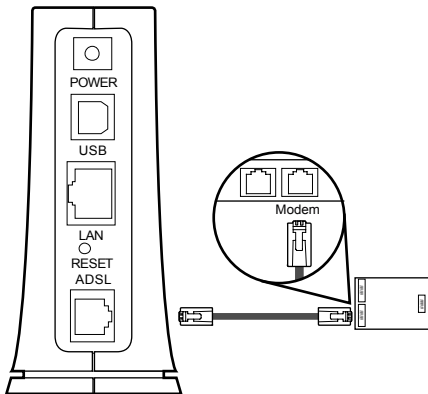

- Step 3** Connect the LAN interface on the MT882a to the Ethernet interface on the computer with a network cable.

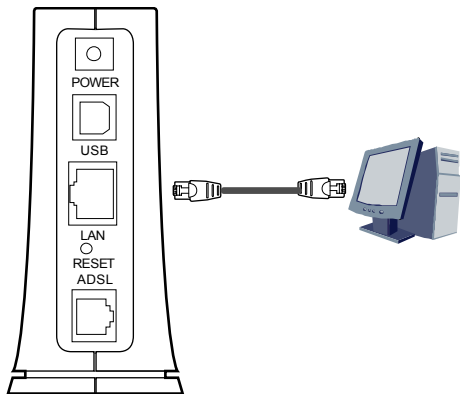

Step 4 Connect the POWER interface on the MT882a to the power socket with the power adapter.

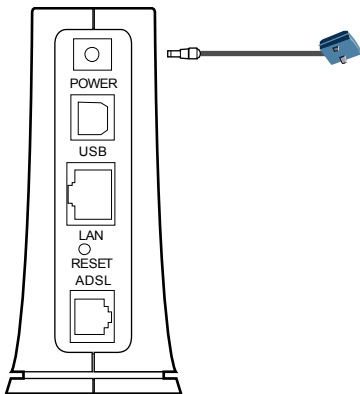

2 Getting Started

Press the power button on the top of the MT882a to power on the MT882a.

After you power on the MT882a, the ADSL indicator blinks (for less than three minutes), which indicates that the MT882a is being activated. After the ADSL indicator stops blinking, the POWER and ADSL indicators turn on, which indicates that the MT882a is working properly.

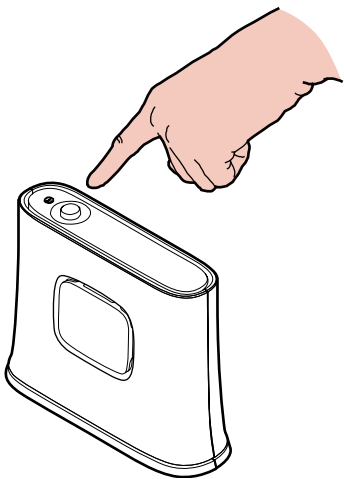

3 Configuring the MT882a



After you enable the embedded dial-up function of the MT882a, when the MT882a is not used for the network access, power off the MT882a. Otherwise, even if you have shut down your computer, the network operator may still charge you for the network access.

Step 1 Log in to the Web configuration page.

1. Launch the Internet Explorer on the computer. Enter **http://192.168.1.1** in the address bar and press **Enter**.
2. In the displayed dialog box, enter the user name and the password, and then click **OK**.

By default, both the user name and the password are **admin**. After the password is verified, you can access the Web configuration page.

Step 2 Enable the embedded dial-up function.

1. In the navigation tree on the left of the Web Configurator, choose **Basic > WAN Setting**.
2. Select a PVC number, such as **1**, from the **PVC** drop-down combo box.
3. Enter the VPI and VCI parameters that are provided by the network operator in the **VPI** and **VCI** text boxes.
4. Select **Yes** from the **Active** drop-down combo box and select **Routing** from the **Mode** drop-down combo box.
5. Enter the user name and password that are provided by the network operator in the **Username** and **Password** text boxes, keep the default settings of other parameters.
6. Click **Submit** to save the settings.

After you complete the preceding settings, you can surf the Internet.

You need to perform the preceding operations on a computer only once. The next time when you power on the computer, you can surf the Internet without performing any configuration.

4 Indicators

Indicator	Status	Description
POWER	On	The MT882a is powered on.
	Off	The MT882a is powered off.
ADSL	Blinking	The MT882a is being activated.
	On	The MT882a is activated.
	Off	The MT882a is powered off.
LAN	Blinking	Data is being transmitted through the Ethernet interface.
	On	The Ethernet connection is established.
	Off	The Ethernet connection is not established.

Indicator	Status	Description
USB	Blinking	Data is being transmitted through the USB interface.
	On	The USB port is connected.
	Off	The USB port is not connected.

Copyright © Huawei Technologies Co., Ltd. 2008. All rights reserved.

No part of this document may be reproduced or transmitted in any form or by any means without prior written consent of Huawei Technologies Co., Ltd.

Trademarks and Permissions



HUAWEI and other Huawei trademarks are trademarks of Huawei Technologies Co., Ltd.

All other trademarks and trade names mentioned in this document are the property of their respective holders.

Notice

The information in this document is subject to change without notice. Every effort has been made in the preparation of this document to ensure accuracy of the contents, but all statements, information, and recommendations in this document do not constitute the warranty of any kind, express or implied.

Issue: 01 (2008-12-24)

Part Number: 102102